

MODLAND

User's Manual

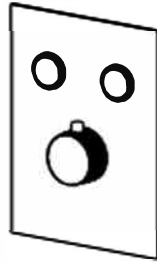

Installation Instructions For Wall Faucet

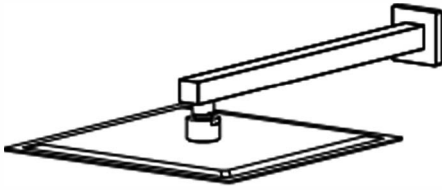

MDSS98015VK

IAPMO RESEARCH AND TESTING, INC.
3001 East Philadelphia Street, Orange, California 91761-2816 • (909) 472-4100 Fax (909) 472-4244 • www.iapmo.org

ANSI **IAPMO** **UPC**

CERTIFICATE OF LISTING

UPC

C

Effective Date: August 2013 **Valid Through:** August 2016

Product: Plumbing Fixture Fittings **File No.:** 8737

Issued To: Fajing Heart Cutridge Co., Ltd.
30, 28 Heishan Dong Road,
Shuihou Town,
Fajing City, GUANGDONG
China

Identification: Plumbing supply fittings complying with this Standard shall be marked with the manufacturer's recognized name, trademark, or other mark or, in the case of private labeling, the name, trademark or other mark of the customer for whom the fitting was manufactured. The marking shall be accomplished by use of a permanent mark or by placing a permanent label on the product. Markings on plumbing supply fittings shall be visible after installation.

Single-handle, single-control, and automatic compensating mixing bath and shower valves shall have identifiable temperature control settings in which the settings are indicated by words ("cold", "warm", "hot", etc.), by numbers, or graphically.

Packages shall be marked with the manufacturer's name, trademark, or other mark as well as the model number or, in the case of private labeling, the name, trademark, or mark of the customer for whom the fitting was manufactured as well as the model number.

David McHenry
Chairman, Product Certification Council

Rene Choung
CEO, The IAPMO Group



This listing is based on the data submitted by the applicant and is not a warranty, endorsement, or approval of the quality, safety, or reliability of the product or the performance of the applicant. It is the responsibility of the applicant to ensure that the product meets the requirements of the Standard. The listing is not a guarantee of performance and does not constitute an endorsement of the product or the applicant. It is the responsibility of the applicant to ensure that the product meets the requirements of the Standard. The listing is not a guarantee of performance and does not constitute an endorsement of the product or the applicant.

IAPMO RESEARCH AND TESTING, INC.
3001 East Philadelphia Street, Orange, California 91761-2816 • (909) 472-4100 Fax (909) 472-4244 • www.iapmo.org

ANSI **IAPMO** **UPC**

CERTIFICATE OF LISTING

UPC

C

Effective Date: October 2008 **Valid Through:** 11/29/2016 **Valid After:** October 2017

Product: Flexible Water Connectors **File No.:** 9505

Issued To: Tuboss Jiamelin Plumbing Hose & Parts Co., Ltd.
Tuboss Industry Zone
Shanghai 201300,
China

Identification: Manufacturer's name or trademark and UPC certification mark. Special note on label: "For use with water in exposed locations only."

Characteristics: Flexible water connectors manufactured in various sizes, lengths and metal and fittings for hot or cold water applications that consist of an inner tube, which may or may not have an outer braided cover. Connectors are to be installed for use in accessible locations only and in accordance with the manufacturer's instructions, and the latest edition of the Uniform Plumbing Code.

Products listed on this certificate have been tested by an IAPMO RIT recognized laboratory. This recognition has been granted based upon the laboratory's compliance to the applicable requirements of ISO/IEC 17025.

Products are in compliance with the following code(s):
Uniform Plumbing Code (UPC)

David McHenry
Chairman, Product Certification Council

Rene Choung
CEO, The IAPMO Group



This listing is based on the data submitted by the applicant and is not a warranty, endorsement, or approval of the quality, safety, or reliability of the product or the performance of the applicant. It is the responsibility of the applicant to ensure that the product meets the requirements of the Standard. The listing is not a guarantee of performance and does not constitute an endorsement of the product or the applicant. It is the responsibility of the applicant to ensure that the product meets the requirements of the Standard. The listing is not a guarantee of performance and does not constitute an endorsement of the product or the applicant.

IAPMO RESEARCH AND TESTING, INC.
3001 East Philadelphia Street, Orange, California 91761-2816 • (909) 472-4100 • (909) 472-4244 • www.iapmo.org

ANSI **IAPMO** **UPC**

CERTIFICATE OF LISTING

UPC

C

Effective Date: November 2018 **Valid Through:** 11/29/2021 **Valid After:** November 2023

Product: Plumbing Fixture Fittings **File No.:** 9528

Issued To: HONGWEI Inc.
171 Hattatouch Heights
Hattatouch, CT 06760

Identification: Each fitting component shall bear permanent legible markings to identify the manufacturer. This marking shall be the trade name, trademark, or other mark known to identify the manufacturer. The product shall also bear all other markings required by the standards. The marking shall be located where it can be readily seen after installation is complete. The product or packaging shall also bear the IAPMO certification mark.

Characteristics: Plumbing fixture fitting equipment to be installed in accordance with the manufacturer's instructions and the requirements of the latest edition of the Uniform Plumbing Code.

Products listed on this certificate have been tested by an IAPMO RIT recognized laboratory. This recognition has been granted based upon the laboratory's compliance to the applicable requirements of ISO/IEC 17025.

Products are in compliance with the following code(s):
Uniform Plumbing Code (UPC)
National Plumbing Code of Canada

Trish Collins *Rene Choung*



This listing is based on the data submitted by the applicant and is not a warranty, endorsement, or approval of the quality, safety, or reliability of the product or the performance of the applicant. It is the responsibility of the applicant to ensure that the product meets the requirements of the Standard. The listing is not a guarantee of performance and does not constitute an endorsement of the product or the applicant. It is the responsibility of the applicant to ensure that the product meets the requirements of the Standard. The listing is not a guarantee of performance and does not constitute an endorsement of the product or the applicant.

BEFORE INSTALLTION

NO.	Name	Qty
1	Shower arm	1
2	Rain shower head	1
3	Hand shower	1
4	Hand shower bracket	1
5	Shower hose	1
6	1/2NPT-1/2NPT Connector	2
7	3/4NPT-1/2NPT Connector	2
8	Swell plastic button	4
9	Main body(Including embedded box)	1
10	Tapping screw	4
11	Cover plate	1
12	Diverter	1
13	Screw(hexagonal)	1
14	Decorative button	1

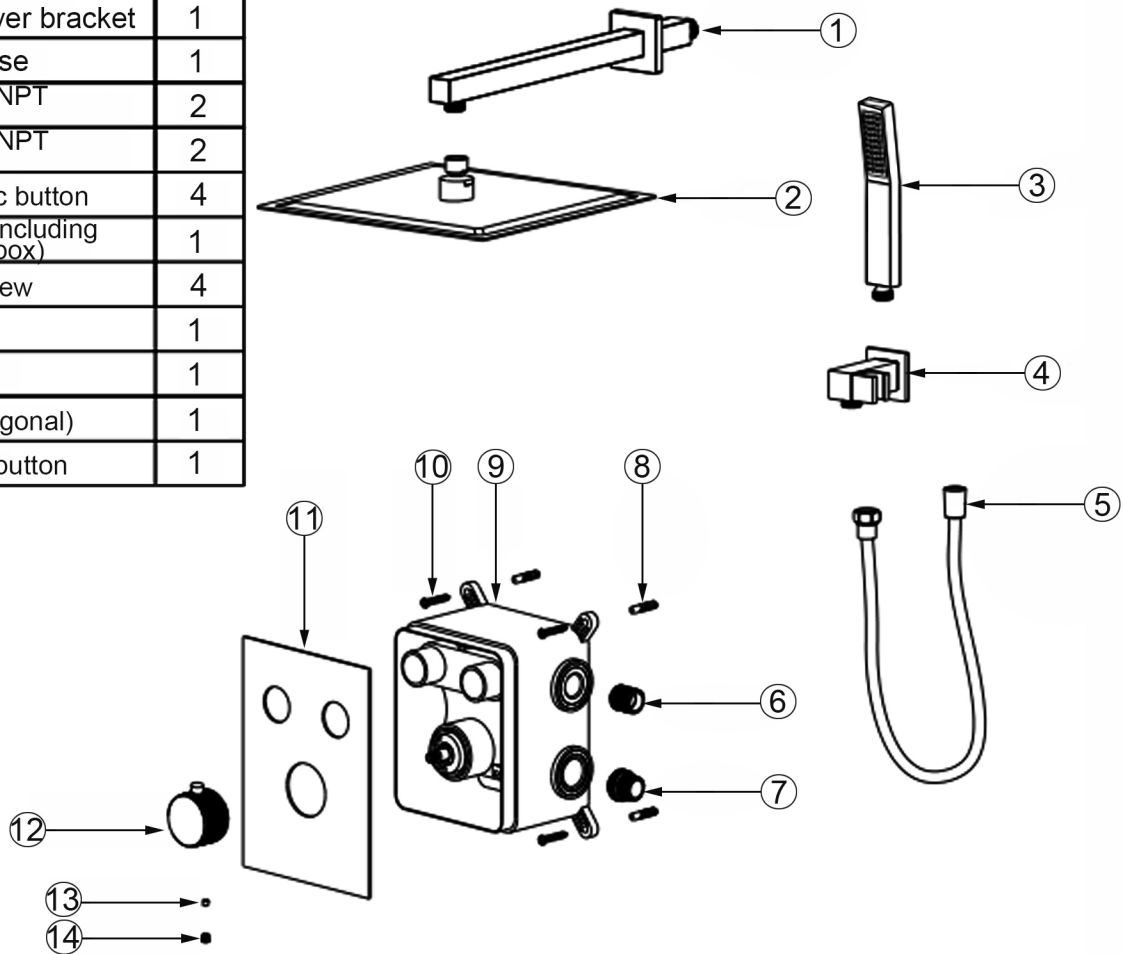

Installation tools and accessories

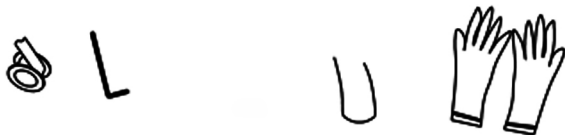

Check accessories

Standard List of Accessories:

When you open the product packaging ,please check whether the objects in it are consistent with the main body and accessories you purchased .If there is any inconsistency ,please contact our company or our distributor.

- Note: 1.Accessories are subject to change without prior notice if the change does not affect usage;
 2.The appearance of the product is subject to the physical objects you receive ,and the schematic diagram is only for reference.

INSTALL THE SHOWER

This product has been inspected and debugged by the factory to the best condition. Please do not disassemble and assemble it yourself.

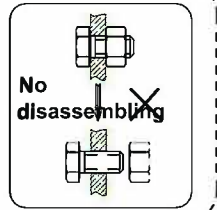

Before installing the faucet, please be sure to remove sundries and sludge from the water pipe to prevent sundries from blocking the faucet.

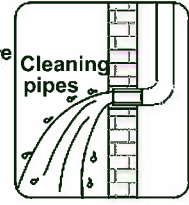

1. Dig pipe grooves for pre-burying pipes.

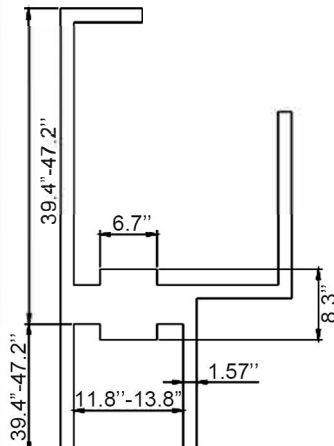

2. Install the main body, water inlet and outlet pipes.

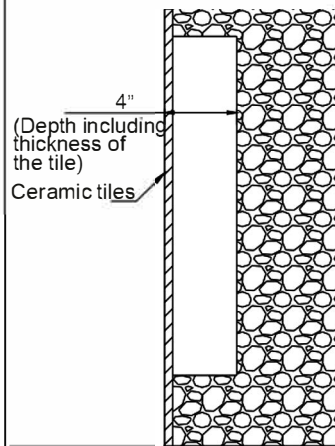

3. Stick tiles. Please note that the outlet should be slightly lower than the surface of the tiles.

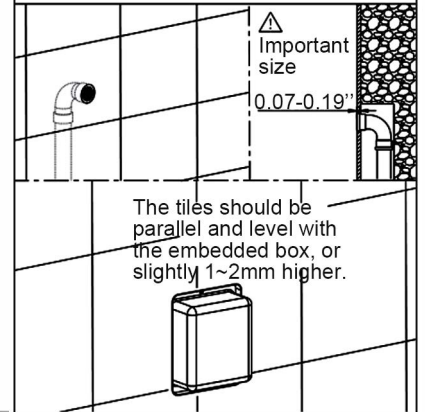

4. Stick the tiles, remove the protecting cover, install the cover plate and diverter.

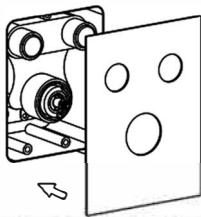

5. Install shower arm and rain shower head. (Wrap the PTFE tape around the thread)

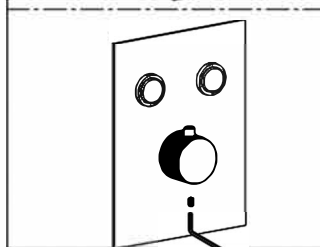
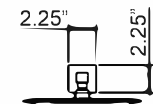
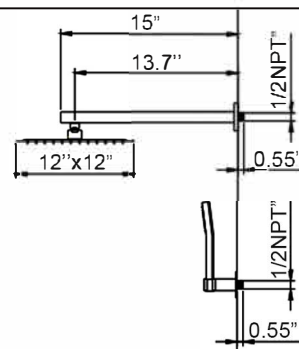
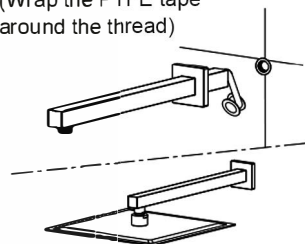

6. Install hand shower bracket. (Wrap the PTFE tape around the thread) (The outlet should be flush with the tile's surface)

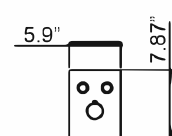
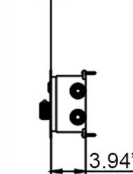
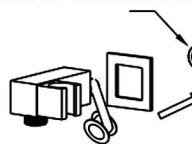

CLEANING CARE

In order to keep the appearance of faucet clean, bright and good performance, please take care of the faucet as follows;

1. Rinse with water only and dry with soft cotton cloth;
2. Use mild liquid and colorless glass cleaner to remove surface dirt and scale film, or use polish without abrasive effect;
3. Do not use abrasive detergent, polish, emery cloth, paper towel or scraper, etc.;
4. Do not use acid cleaner, or cleaner and soap with insoluble gran etc.;
5. In the process of use, mud may accumulate in the bubbler and make the water flow show, The bubbler can be unscrewed, rinsed with water, and then installed back in place.



Please feel free to contact us if you have any questions. We will help to solve the issue together with you.

